



TWIN STATE
BASEMENT SERVICES

Town of Richmond
203 Bridge St
Richmond, VT 05477

August 21, 2024

PROPOSAL

Twin State Basement Services (TSBS) inspected the basement at the above address. There is a water infiltration problem in two areas of the building. A careful inspection revealed that the water is coming up from hydrostatic pressure under the floor. This will continue as the rains and wet weather continues.

Proposed Remedy: TSBS proposes to install the Grate Drain™ system approximately 47 feet around the perimeter of the art room. We will trench out right under the floor, then place the drain with crushed stone surrounding it. TSBS proposes to a sump pit with a closed sump liner/basin. In those liners will be a Fast Sump as well as an option to add a [Pro-Series PHCC-2400 Battery Back Up Sump Pump](#) with a Pro Series [Marine Battery](#). The sump liners will be surrounded by crushed stone and sealed with a concrete finish that's even with the floor. The primary pump itself has a 4amp draw with a steady capacitor to keep it running very efficiently and quietly. The pump has a warranty of 4 years if installed by a Healthy Basement Contractor.

On the walls, we will place ThermalShield™, a 90 mil wall vapor barrier that's Class A (Fire Rated) made of 3 layers; foil, foam, and poly. It's foil face reflects indoor heat back into the basement space, while the foam the cold from the basement walls out, and polyethylene plastic sheeting to keep out moisture. Save energy and protect against moisture, mold, mildew, humidity, and potential wall leaks. Perm rating for ThermalShield is .014. This will prevent future leaks from the stone foundation to enter the basement.

In the Furnace Room a pump and battery back up are *recommended* to protect the furnace room. This will also be installed in the lowest area and exit out the window where the furnace does. Please note you can take cost off directly from itemized proposal.

A Santa Fe Oasis Dehumidifier will also be installed in the furnace room at material cost.

The total for this project is \$13,535. To schedule this project, Twin State Basement Services requires a 30% deposit. Remaining balance (70%) is paid to Project Foreman on last day of project.

Estimate Project Duration: 1-2 days

Twin State Basement Services

7 Ewing Place, Unit C
 Essex Junction, VT
 05452
 Tel: 802-839-8559

Basement Proposal		Date: 8/20/2024	Customer #
Customer Name:	Town of Richmond	Home Phone:	cc: Duncan Wardwell
Address:	203 Bridge Street	Cell Phone:	802-578-1705
City/State/Zip:	Richmond, VT 05477	Email:	dwardwell@richmondvt.gov

Description:

Grate Drain TM Basement Drainage System - custom built	47 ft		\$5,875
Grate Trench TM Basement Surface Drainage System			
Fast Drain TM Basement Drainage System			
SUMP PUMP:			
FastSump Pump TM 1/3 HP sump pump (2400gph) Float Switch	2		\$3,800
FastSump Pump TM 1/3 HP sump pump (2400 gph) w/ dual controller			
Grate Sump TM Liner w/ PS3033 1/3 HP Sump w/ deluxe controller			
Grate Sump TM Liner w/ PS3050 1/2 HP Sump w/ deluxe controller			
BATTERY BACK-UP			
GrateSump + TM 1/3 HP - (2400gph) w/ AC or DC power (1) Battery			
GrateSump TM with PHCC2400 Battery Back Up System/(1) Battery			
GrateSump + II TM (2) 1/3 hp (4800gph) w/ AC or DC pwr(2) Battery			
GrateSump + Pro-Series PHCC-2400 Battery Back Up (2400 gph)	2	material cost	\$2,000
BASEMENT PRODUCTS:			
ThermalShield TM basement 90 mil Wall insulation (foil / foam / poly)	47 ft		-----
Crawlshield TM Crawl Space Barrier (white woven poly)			
Santa Fe Oasis Dehumidifier	1	material cost	\$1,850
Delta-Matting (double-dimpled membrane)			
Flexi-Flange (1 ft vapor barrier)			
FOUNDATION SUPPORT:			
The Force - structural tension-loaded, steel i-beam reinforcement			
Foam Board Insulation (4'x8' -- 2 feet below grade)			
3" galvanized steel columns w/ engineered base			

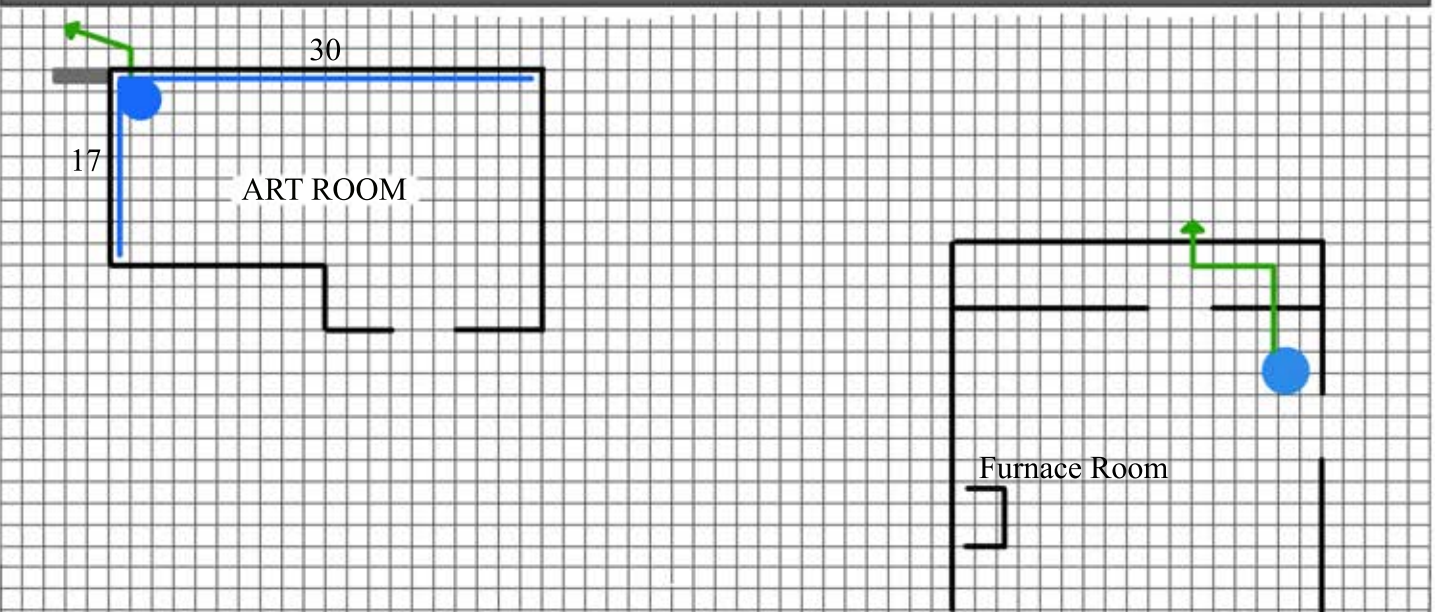

State Basement Services. Sump pumps and Back-Ups come with a 1-3 year manufactureres warranty.
 100 amp battery comes with a 1 yr warranty.

Payment Method	<input type="checkbox"/> credit card	<input type="checkbox"/> Check #	30% deposit
			Total: \$13,525

Project Manager's Signature: _____ Date: _____
 Homeowner's Signature: _____ Date: _____